



#### Dimensions

Product dimensions (mm) 157 x 564 x 62

#### Scheme

Scheme

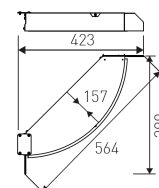

#### Product

|                             |                    |
|-----------------------------|--------------------|
| Real power (W)              | 11/16              |
| Real luminous flux (Lm)     | 890/1436           |
| Luminous efficiency (Lm/W)  | 80/90              |
| Beam angle (°)              | 110                |
| Life time (h)               | 60000 (L80B10)     |
| IP                          | 20                 |
| IK                          | 04                 |
| Electrical class insulation | Class 1            |
| Photobiological risk        | 0 - Exempt         |
| Operating temperature       | from 5°C to 30°C   |
| Colour                      | White              |
| Energy efficiency class     | A+                 |
| Diffuser                    | PMMA opal diffuser |

#### Control gear

Control gear DALI Dimmable Electronic Control Gear

#### Light source

|                            |            |
|----------------------------|------------|
| Light source included      | Yes        |
| Light source               | Led        |
| Nominal power (W)          | 8/13       |
| Nominal luminous flux (Lm) | 1100/18000 |
| Average life time (h)      | 60000      |
| Colour temperature (K)     | 4000       |
| Colour consistency (SDCM)  | 3          |
| CRI                        | 80         |

#### Accessories

|               |  |
|---------------|--|
| AG00SLR300-SZ | Stencil to cut ceiling panels for mosaic references AG00SMEPL1811APLX & AG00SMEPL1811APLXD.  |
| AG00SME-ZDA1  | Electronic non dimamable gear & connection cable for feeding mosaic luminaires AG00SMEPL2213APLX & AG00SMEPL1811APLX runned at 16W.  |
| AG00SME-ZDB1  | Electronic DALI dimamable gear & connection cable for feeding mosaic luminaires AG00SMEPL2213APLX & AG00SMEPL1811APLX runned at 11W. |

## Gridding ceiling recessed curved module for continuous light pattern design from the Mosaic TROLL family.

### DESCRIPTION

Gridding ceiling recessed curved module for continuous light pattern design from the Mosaic TROLL family. Luminaire set an advanced and innovative thermal balance system through passive dissipation with stable colour temperature of 4000° K (cold white) optimised to be used as general lighting in offices, Schools, commercial centres etc. Luminaires has been designed to be recessed in suspended gridding ceilings. Luminaire housing is made of steel sheet, coated with white (RAL 9016) powder paint resistant to UV. Luminaire build in a PMMA opal diffuser and high efficiency LED light sources with CRI higher than 85 % and a chromatic dispersion lower than 3 SMCD which can work at 8w or 13W depending on the gear we use. Fixture has a luminous flux of 890/1436 Lm, with an efficiency of 80/90 Lm/W and a total consumption of 11/16 W. The average life for the luminaire is 60000 (L80B10) h (established at a minimum flux of 70 % from the original). Luminaire needs a DALI Dimmable control gear fed at 220-240V; 50/60 Hz.(see accessories).

|                           |   |
|---------------------------|---|
| Item code                 | 00SMEPL1811APLXD  |
| Product type              | IN  |
| Category                  | Architctural  |
| Family                    | Mosaic  |
| Subfamily                 | Mosaic Led  |
| Materials                 | Luminaire housing is made of steel sheet, coated with white (RAL 9016) powder paint resistant to UV.  |
| Optical system            | Luminaire build in a PMMA opal diffuser and high efficiency LED light sources.  |
| Installation instructions | Luminaires has been designed to be recessed in suspended gridding ceilings. Luminaire needs a DALI Dimmable control gear fed at 220-240V; 50/60 Hz.(see accessories). |

Pictograms

