

# troll

## L I C O

1850S/2145...  
1850S/2985...  
1850S/1305RGB  
1850S/2145RGB  
1850S/2985RGB

1850SI/1305...  
1850SI/2145...  
1850SI/2985...  
1850SI/1305RGB  
1850SI/2145RGB  
1850SI/2985RGB

1850/1305../..  
1850/2145../..  
1850/2985../..  
1850/130RGB../..  
1850/214RGB../..  
1850/298RGB../..

1850/T/221  
1850/E/221  
1850/U/17  
1850/A/17



ISO 9001

LUXIONA

Tel. (00 34) 938 466 909  
Fax. (00 34) 938 465 709  
e-mail. Info@troll.es

www.troll.es  
www.luxiona.com

INSTRUCCIONES DE MONTAJE  
ASSEMBLY INSTRUCTIONS  
INSTRUCTIONS DE MONTAGE  
ISTRUZIONI DI MONTAGGIO  
MONTAGE ANLEITUNG

1850S/1305..., 1850S/2145..., 1850S/2985..., 1850S/1305RGB, 1850S/2145RGB, 1850S/2985RGB,  
1850SI/1305..., 1850SI/2145..., 1850SI/2985..., 1850SI/1305RGB, 1850SI/2145RGB, 1850SI/2985RGB

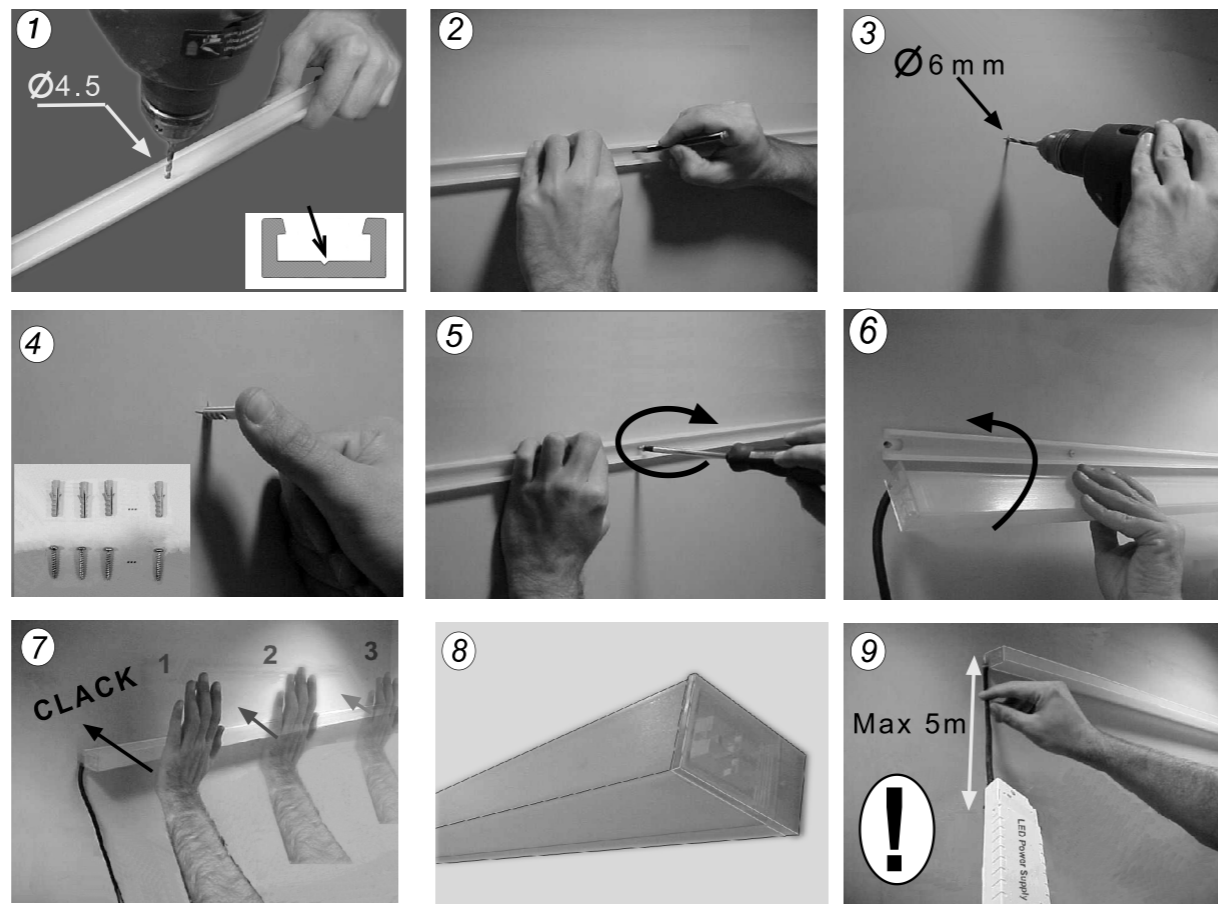

1850S/1305..., 1850S/2145..., 1850S/2985...,  
1850SI/1305..., 1850SI/2145..., 1850SI/2985...

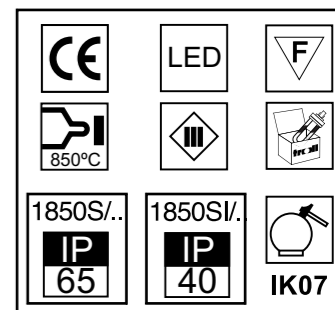
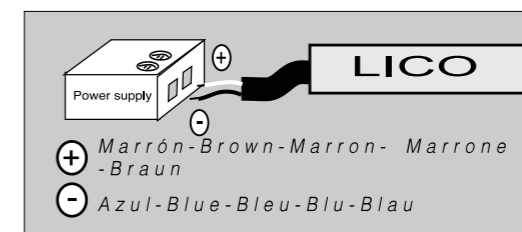

1850S/1305RGB, 1850S/2145RGB, 1850S/2985RGB

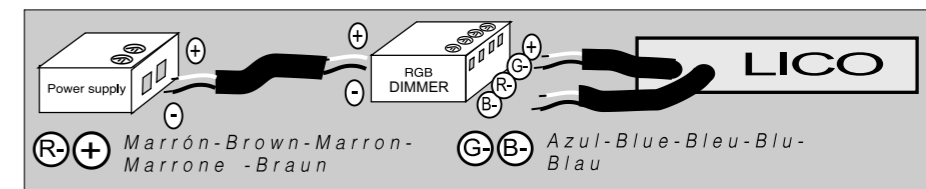

1850SI/1305RGB, 1850SI/2145RGB, 1850SI/2985RGB

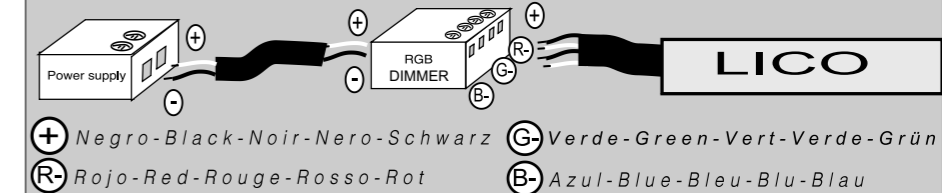

1850/1305..., 1850/2145..., 1850/2985..., 1850/130RGB..., 1850/214RGB..., 1850/298RGB...

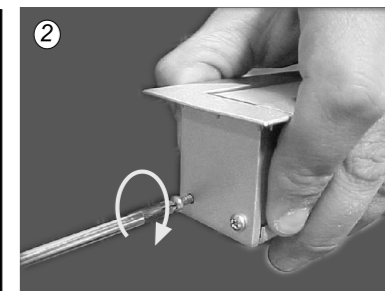
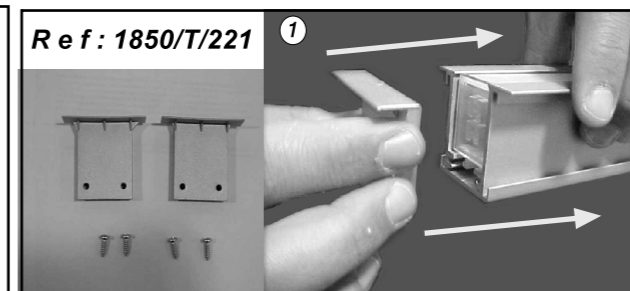
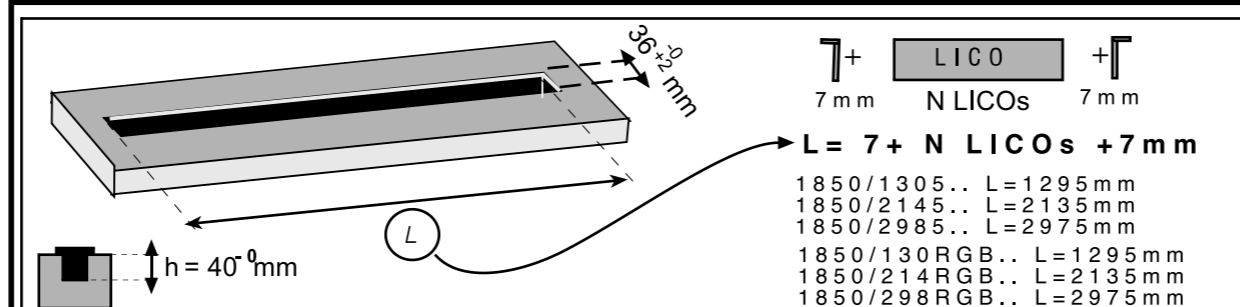

1850/1305..., 1850/2145..., 1850/2985...

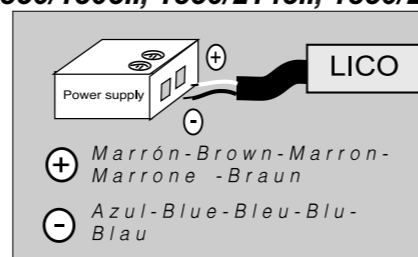
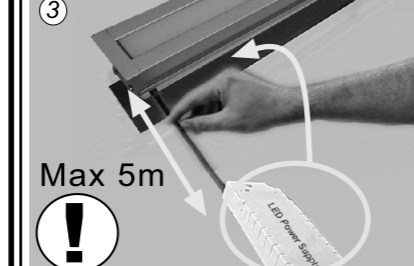

1850/130RGB..., 1850/214RGB..., 1850/298RGB...

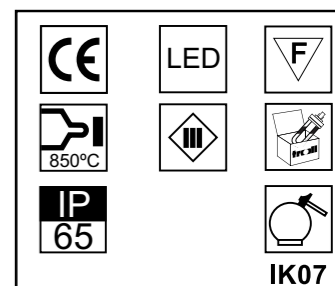
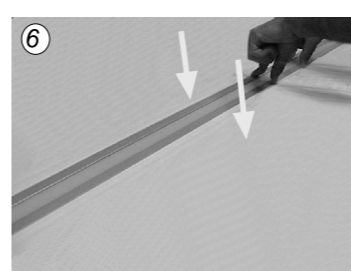
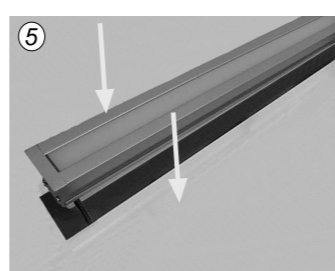
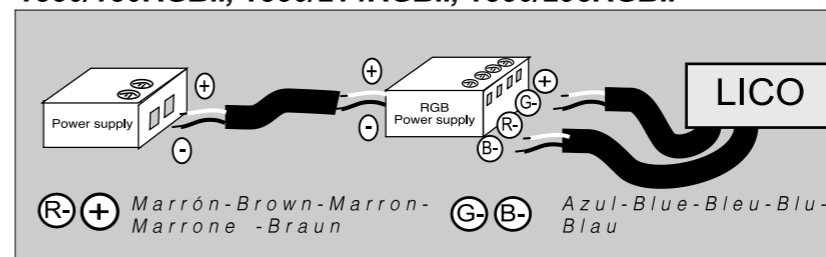

Figure 1 illustrates the assembly process of the microfluidic device in seven steps:

1. Components: two metal strips, a small screw, and a hex key.
2. Inserting the strip into the channel.
3. Tightening the screw with the hex key.
4. Completed assembly of the channel.
5. Inserting the strip into the next channel.
6. Tightening the screw.
7. Final assembly with multiple channels.

9 m m ~ 20 m m

36 m m

1

2

3

4

5

1850/1305... → 2 x 1850/M  
 1850/2145... → 3 x 1850/M  
 1850/2985... → 4 x 1850/M

Technical drawing of the 1850/E/221 and 1850/A/221 cable management system. The drawing shows a cross-section of the system with dimensions: L (length), 42mm (width), 7mm (thickness), and L' (height). The formula for the length is given as  $L = L' + 7 + N \text{ LICOs} + 42 \text{ mm}$ .

Assembly steps 1 through 9 are shown in a grid of images:

1. Initial assembly of the 1850/E/221 and 1850/A/221 components.
2. Inserting the cable into the system.
3. Securing the cable with the LICO (cable lock).
4. Tightening the LICO with a screwdriver.
5. Final assembly of the 1850/A/221 component.
6. Final assembly of the 1850/E/221 component.
7. Final assembly of the 1850/A/221 component.
8. Final assembly of the 1850/E/221 component.
9. Final assembly of the 1850/A/221 component.



24V, 150W



24V, 70W, Ip67



24V, 130W, Ip67



24V, 100W



**24V, 60W**

**70/1850/15; 70/1850/25**  
**70/1850/30; 70/1850/70**

Diagram illustrating the connection of a 70/1850RGB/R LED strip to a power supply and a LICO 1 RGB LED strip.

The 70/1850RGB/R LED strip is connected to a Power supply (24V) via terminals labeled 24V, D, and ground. The strip is divided into segments, each containing four LEDs (R, B, G, R).

The LICO 1 RGB LED strip is connected to the 70/1850RGB/R strip via terminals labeled R, B, G, and +. The connection is shown with a dashed line labeled LICO N RGB.

The diagram also shows a warning symbol and the text  $(d + D)_{\max} = 5 \text{ m}$ , indicating a maximum distance constraint.

Diagram illustrating the connection of the 70/1850RGB/S module. The module is powered by a 24V supply (D) and has a 1-10V potentiometer. The module outputs are connected to LICO 1 RGB, LICO 2 RGB, ..., LICO N RGB. The diagram shows the wiring for the RGB channels, with red, green, and blue lines connecting the module outputs to the LICO inputs. A note indicates that the maximum distance (d + D) is 5 m.